



UNITED FRANCHISE GROUP WORLD EXPO  
APRIL 15-18, 2012

2012 WORLD EXPO  
EXHIBIT SPACE REGISTRATION FORM

Main Contact:

Company: \_\_\_\_\_  
Contact Person: \_\_\_\_\_  
Title: \_\_\_\_\_  
Address: \_\_\_\_\_  
City: \_\_\_\_\_ State: \_\_\_\_\_ Zip: \_\_\_\_\_  
Phone: \_\_\_\_\_ Ext. \_\_\_\_\_ Fax: \_\_\_\_\_ E-Mail Address: \_\_\_\_\_

Billing Contact:

Contact Person: \_\_\_\_\_  
Address: \_\_\_\_\_  
City: \_\_\_\_\_ State: \_\_\_\_\_ Zip: \_\_\_\_\_  
Phone: \_\_\_\_\_ Ext. \_\_\_\_\_ Fax: \_\_\_\_\_ E-Mail Address: \_\_\_\_\_

Exhibit Booth Pricing

*(Booth Price Includes: pipe & drape, 1 table, 2 chairs, 1 waste basket, ID sign and lunch on show days. Includes 2 registrants complimentary and each additional at \$79.00 – if staying @ The Rio All-Suite Hotel & Casino.)*

10' x 10' Booth: Corner booths add \$100.00

Reserved by February 15, 2011: \$2,000 (1<sup>st</sup> booth)  
\$1,700 (each additional booth)  
February 16, 2011 to December 31, 2011: \$2,300 (1<sup>st</sup> booth)  
\$1,900 (each additional booth)  
Reserved after December 31, 2011: \$2,500 (1<sup>st</sup> booth)  
\$2,000 (each additional booth)

10' x 20' Front End Cap Booths:

Reserved by February 15, 2011: \$4,500  
February 16, 2011 to December 31, 2011: \$5,000  
After December 31, 2011: \$5,500

20' x 20' Booths:

Reserved by February 15, 2011: \$6,000  
February 16, 2011 to December 31, 2011: \$7,000  
After December 31, 2011: \$8,000

20' x 30' Booths:

Reserved by February 15, 2011: \$7,500  
February 16, 2011 to December 31, 2011: \$8,500  
After December 31, 2011: \$9,500

Booth Selection: 1<sup>st</sup> choice \_\_\_\_\_ 2<sup>nd</sup> \_\_\_\_\_ 3<sup>rd</sup> \_\_\_\_\_

Total Number of Booths: \_\_\_\_\_

Exhibiting For:  SIGNARAMA  EmbroidMe  General Services

Payment

Total Amount Due: \$ \_\_\_\_\_

Payment Method:  Check **(PAYABLE TO: World Expo)**

MasterCard  Visa  American Express (3 digit code on back of card) \_\_\_\_\_

Credit Card Number: \_\_\_\_\_ Exp. Date: \_\_\_\_\_

Authorized Signature \_\_\_\_\_ Date \_\_\_\_\_

**\*\*Payment in full must accompany form in order to secure exhibit space.**

Send Form & Payment to Corporate Events **(Check payable to: World Expo):**

7431 114<sup>th</sup> Avenue North, Suite #102 • Largo, Florida 33773

phone: (727) 548-7200 fax: (727) 546-1956

e-mail: [info@CorporateEvents-tampabay.com](mailto:info@CorporateEvents-tampabay.com)

## Contract For Exhibit Space 2012 World Expo

**CONTRACT:** This Contract for Exhibit Space, when properly executed by a company/organization and submitted with or without full or partial payment of fee, and accepted in writing by Sign\*A\*Rama Inc., EmbroidMe.com, Inc., Billboard Connection, Inc., and Plan Ahead Events, Inc. (hereinafter referred to as the "COMPANIES"), shall be considered a binding Contract between the two parties subject to the rules and regulations promulgated by the COMPANIES pursuant to this Contract. The contracting company/organization and the COMPANIES agree that the purpose of the Expo is professional education of persons attending the Expo and will conduct themselves accordingly. The COMPANIES reserve the right to determine the Exposition eligibility of any company/organization, product or service.

**EXPOSITION SITE AND TIME:** The Exposition will be held April 15-18, 2012 at The Rio All-Suite Casino Resort in Las Vegas, NV. The Exhibit Show portion of the Expo will be open according to the following schedule:

DAY	DATE	OPENING	CLOSING	EVENT
Sunday	4/15/12	8:00 am	8:00 pm	Exhibitor Move-in
Monday	4/16/12	10:00 am	4:00 pm	Exhibit Show Hours (All Brands)
Tuesday	4/17/12	10:00 am	4:00 pm	Exhibit Show Hours (SAR & EME Only)
Tuesday	4/17/12	4:00 pm	11:00 pm	Exhibitor Move-out

The COMPANIES reserve the right to change the date, site and exhibit hours; however, any such change(s) will be made known as far in advance of the Exposition as possible, and Exhibitors will be notified accordingly. During all hours the Exposition is open, the Exhibitor must occupy its assigned exhibit space, and staff its exhibit with competent personnel. Exhibitor shall not dismantle its exhibit or otherwise interfere with the orderly conduct of the Exposition until it is finally closed to visitors.

**CANCELLATIONS:** Exhibitor specifically recognizes and agrees that the COMPANIES will sustain losses in the event the Exhibitor fails to provide timely written notice of cancellation (by certified mail). In keeping with industry practice, the existence of which practice is acknowledged by the Exhibitor, and in view of such losses as cannot be precisely measured but which include inability to replace those canceling late, advertising, credibility, redesigning of floor spaces, and alike, the Exhibitor agrees upon the following late cancellation assessment schedule as being in the nature of liquidated damages, which schedule is designed specifically to compensate the COMPANIES for its losses and not constitute a penalty, should the Exhibitor fail to provide timely written notice, by certified mail, of cancellation of all or any part of its assigned booth space.

DATE OF CANCELLATION	ASSESSMENT (% of rental fee for space canceled)
<u>January 31, 2011 to September 30, 2011</u>	50%
<u>After September 30, 2011</u>	100%

Cancellations will be accepted only in accordance with the above schedule. There will be no refunds for cancellations received after September 30, 2011. Any refunds due Exhibitor as the result of cancellation of this Contract will be made after the completion of the Expo. Failure to make full payment of exhibit space rental fees by date indicated on invoice on a Contract filed prior to, or on, that date; will subject Exhibitor to cancellation of Contract by the COMPANIES and liability for balance due. If booth space is not occupied on, Monday, April 16, 2012, the COMPANIES shall have the right to use such space. Reletting by the COMPANIES of an Exhibitor's canceled space shall not act to excuse Exhibitor from assessment.

Except as the Exhibitors rental obligation may be reduced through cancellation and refund in accordance with the above schedule, the Exhibitor is responsible for the total exhibit space rental fees irrespective of the reason for cancellation, including cancellation by the Exhibitor because of the failure of the exhibit to arrive for any reason, or cancellation by the COMPANIES of the Exposition in whole or in part as a result of riot, strike, civil disorder, act of war, act of God, or any reason of any kind whatsoever not within the COMPANIES control. However, in such instances of the COMPANIES cancellation, the COMPANIES will make every reasonable effort to reschedule or conduct the Expo in spite of such acts or circumstances beyond its control. Should it ultimately be impossible to hold the Expo in such instances the COMPANIES may retain and/or will be due such part of the Exhibitor's exhibit space rental fees as shall be required to the COMPANIES for expenses incurred up to the time a contingency beyond its control shall have occurred. All payments in excess of such expenses will be refunded.

**USE OF SPACE:** Exhibitor agrees not to assign, sublet or share allocated space without the knowledge and prior written consent the COMPANIES. Exhibitor will not be permitted to display outside the confines of the assigned booth space in the Exposition area. Exhibitor must show only products or services dealt in during the regular course of its business and approved by the COMPANIES. Except as specifically allowed by the COMPANIES, Exhibitor may not promote or represent any other vendor's products or services in its booth. Unless part of a demonstration, or integrated into a solution provided by Exhibitor, no other vendor's hardware or software may be exhibited. Signs or banners, printed materials such as specification sheets or brochures, advertising or any other form of promotion which suggests another vendor's presence as an exhibitor within Exhibitor's space are strictly forbidden. Violation of these regulations, or failure to correct such a violation, may result in removal of Exhibitor's booth from the Exposition by the COMPANIES.

**AVAILABLE SERVICES:** On behalf of the Exhibitor, the COMPANIES have designated an official Exposition contractor to provide the following: drayage, machinery moving, cartage, machinery erection, furniture, booth and floor decorations, signs, photographs, etc. Services of electricians, plumbers, carpenters and other labor will be available and charged for at the then-prevailing rates. Contractors and rates will be listed in the Exhibitor Service Kit to be issued separately. The COMPANIES assume no responsibility or liability for any of the services performed or materials delivered by the foregoing persons, parties and organizations. Arrangement for these services and payment are to be made between Exhibitor and official Exposition contractors.

**INSURANCE:** The COMPANIES shall not be liable for damage or loss to any Exhibitor's properties through theft, fire, accident or any other destructive cause, whether the result of negligence or otherwise. Exhibitor shall insure its own exhibit and display materials. Exhibitor must carry Public Liability Insurance with limits of not less than \$500,000.00 any one injury, \$1,000,000.00 any one accident, and \$250,000.00 property damage. Exhibitor will obtain a waiver from its said insurance carrier(s) subrogation rights against the COMPANIES, and their respective officers, employees and agents. The COMPANIES assume no liability for injury that may occur to visitors to the Exposition or for any damage to any property. Exhibitor agrees to indemnify, defend, and hold harmless the COMPANIES, their respective officers, employees and agents, against all claims for bodily injury, property damage, and or any other claim arising out of Exhibitor's participation in the Exposition, or caused by its employees, representatives, contractors, or property in its possession or control.

**HEIGHT AND CONSTRUCTION RESTRICTIONS:**

- (A) The standard exhibit booth equipment has a back wall 8 feet high and dividing sidewalls 3 feet high. The rear half of each sidewall may extend to the height of the back wall. The front half of the sidewall can be no higher than 3 feet.
- (B) Equipment or a product that is an integral part of the display, but not part of the booth, may extend above the back wall if approved in advance, in writing, by the COMPANIES.
- (C) In no instance will the exhibitor be permitted to install any item or structure (signs, booth structure, product, etc.) above height of the back wall without advance approval, in writing, by the COMPANIES .
- (D) All materials within the exhibit booth area including, but not limited to: actual display unit, decorative items, furnishings, labels, flooring, etc. must meet and comply with all national and local facility fire, electrical, plumbing, safety and hazardous material codes. Proper written certification must be available to the COMPANIES at the exhibitor's expense.
- (E) The COMPANIES retain sole discretion and authority in the placement, arrangement and appearance of all displays.

**STORAGE OF PACKING CRATES AND BOXES:** Exhibitors will not be permitted to store packing crates and/or boxes within their exhibit space during the Exposition. These items, when properly marked, will be stored and returned to the booth by the Exposition contractor at the expense of the exhibitor. It is the exhibitor's responsibility to mark and identify their crates and boxes as soon as they are empty or otherwise ready for removal to facilitate the opening of the Exposition. Crates and boxes not properly marked or identified may be lost or destroyed and are not the responsibility of the COMPANIES, their agents and contractors, the Exposition contractor, the facility, or any other representative thereof.

**MEETING ROOMS AND HOSPITALITY OR SPECIAL FUNCTIONS:**

- (A) The assembling of attendees in any meeting room, hotel suite, or special function room by any exhibitor or organization must be approved in advance, in writing by the COMPANIES.
- (B) Use of meeting facilities or hotels by exhibitors or organizations for sales or business meetings or meal functions, during the meeting dates, must be approved in advance, in writing by the COMPANIES.
- (C) Violations of the above are grounds for expulsion from the exhibit area and/or restriction from participation in any future Expo's of the COMPANIES.

**DISABILITY PROVISIONS:** Exhibitor represents and warrants that (a) that its exhibit will be accessible to the full extent required by law. (b) that its exhibit will comply with the Americans with Disabilities Act (ADA) and with any regulations implemented by the ADA including, but not limited to: 36" pathways, ramp capabilities for raised or lowered flooring, and installation of tightly woven carpeting less than 1½" thick to facilitate wheelchair movement. (c) that it shall indemnify and hold harmless the COMPANIES, their agents and contractors, the Exposition contractor, the facility, or any other representative thereof from and against any and all claims and expenses, including attorney's fees and litigation expenses, that may be incurred by or asserted against the COMPANIES, its agents and contractors, the Exposition contractor, the facility, or any other representative thereof on the basis of the exhibitors breach of this paragraph or non-compliance with any of the provisions of the ADA.

**ROYALTIES AND OTHER PAYMENTS:** Exhibitor agrees to pay promptly all royalties, license fees, or other charges due to any person, firm, or corporation by reason of any live or recorded music, or any other kind of entertainment, which the exhibitor, its agents, employees, or subtenants plays, stages, or produces within the premises covered by this Contract, including, but not limited to royalties or licensing fees due to BMI, ASCAP, or SESAC. Exhibitor agrees to indemnify and hold harmless the COMPANIES, their agents and contractors, the Exposition contractor, the facility, or any other representative thereof from and against any and all claims and expenses, including attorney's fees and litigation expenses, that may be incurred by or asserted against the COMPANIES, their agents and contractors, the Exposition contractor, the facility, or any other representative thereof on the basis of the exhibitors breach of this paragraph.

**UNION LABOR:** Exhibitor is required to observe and comply with all union regulations for the state in which the event is being held, as well as contracts with the facility in which the event is taking place, official service contractors and union labor organizations.

**EXHIBITOR APPOINTED CONTRACTORS:** Exhibitors using companies other than the official Exposition contractor must advise the COMPANIES in writing of their intent no later than 30 days prior to the first day of installation. An Exhibitor Appointed Contractor (EAC) is a company or individual other than the official Exposition contractor listed in this Contract. EAC's may be present to handle supervision, but are NOT allowed to perform work on-site, or perform labor and equipment unless they are members of the local union jurisdiction. Exhibitors utilizing EAC's agree to indemnify and hold harmless the COMPANIES, their agents and contractors, the Exposition contractor, the facility, or any other representative thereof from and against any and all claims and expenses, including attorney's fees and litigation expenses, that may be incurred by or asserted against the COMPANIES, their agents and contractors, the Exposition contractor, the facility, or any other representative thereof which may arise due to third party contractor's presence or actions. Exhibitor accepts full responsibility for any EAC employed on their behalf and agrees to educate EAC on all show rules and regulations. EAC must provide proof of insurance to the COMPANIES no less than 30 days in advance of installation. Coverage must include General Liability and Automotive Liability Insurance with limits of not less than \$1,000,000.00 any one injury, \$1,000,000.00 any one accident, and \$250,000.00 property damage, Worker's compensation as required in the state in which the event is taking place, and Employer's Liability of \$100,000. Umbrella Form Excess Liability may be used to bring coverage up to these requirements. Exhibitor will obtain a waiver from its said insurance carrier(s) of carrier's(s') subrogation rights against the COMPANIES, and their respective officers, employees and agents.

**OTHER TERMS AND CONDITIONS:** Exhibitor shall comply with all fire laws, electrical codes and all other rules, regulations, codes or statutes with respect to the installation, conduct and disassembly of its exhibit. Exhibitor shall also comply with all reasonable requests the COMPANIES and the facility officials with respect to the installation, conduct and disassembly of its exhibit. The exhibit shall be conducted in a decorous manner in order not to be objectionable to other Exhibitors, the facility, the COMPANIES or the public. The COMPANIES and the facility reserve the right to close, remove or require changes in any exhibit or to remove any of the Exhibitor's personnel, agents, representatives, independent contractors, invitees or guests who are deemed detrimental to the overall Exposition, the facility, and other Exhibitors or public.

The license granted by this Contract is personal and may not be transferred without the written consent of the COMPANIES. The premises are licensed on as "as is" basis, and the COMPANIES will not be liable for pre-existing conditions of the premises or for conditions arising during the period of the license. Exhibitor shall return the premises in as good as condition as they were received. The COMPANIES shall in no event be liable to the Exhibitor in excess of any consideration paid by the Exhibitor to the COMPANIES, and received by the COMPANIES for breaches of Contract or tortuous conduct by the COMPANIES, their agents, representatives and independent contractors whether acting within or of the scope of their authority; by agents, representatives or independent contractors of the facility, or by the general public. The COMPANIES shall not be liable for failure to perform its obligations under this Contract due to strikes, riots, acts of God, or any other cause beyond its control. Anyone visiting, viewing or otherwise participating in the Exhibitor's booth is deemed to be the invitee or licensee of the Exhibitor rather than the invitee or licensee of the COMPANIES.

The COMPANIES shall not be liable for injury of any type from any cause to property of the Exhibitor or to persons conducting or otherwise participating in the conduct of the exhibit or to invitees or guests of the Exhibitor. Exhibitor assumes full responsibility and liability for the actions of its agents, employees or independent contractors, whether acting within or outside of the scope of their authority, and agrees to hold harmless the COMPANIES from responsibility or liability resulting directly or indirectly, or jointly, from other causes which arise because of the actions or omissions of its agents, employees or independent contractors, whether acting within or outside of the scope of their authority.

Within Exhibitor by entering into this Contract agrees in the event of any disputes arising out of it to accept the jurisdiction of the State of Florida. In the event of any breach of any term of this Contract by the within Exhibitor, or other dispute arising out of this Contract, Exhibitor will be liable, from and after default, for interest on such money as are owed by Exhibitor at the rate of one and one-half percent (1 ½%) per month commencing on the date of initial demand. In addition, Exhibitor will be liable for all reasonable costs, expenses and attorneys fees arising out of the collection efforts of the COMPANIES, which, when combined with said interest, shall not, in any event, exceed the usury law of the jurisdiction in which said claim is filed.

The COMPANIES makes no representations or warranties to Exhibitor of any nature or kind. This contract contains all of the terms and conditions of the parties' Agreement regarding this subject matter.

By signing below, I acknowledge that I have received a complete Contract and am duly authorized to sign and bind Exhibitor to it and all the terms and conditions as set forth herein.

**EXHIBITOR:** Company \_\_\_\_\_  
Name (Type or Print) \_\_\_\_\_  
Title \_\_\_\_\_  
By (Authorized Signature) \_\_\_\_\_ Date \_\_\_\_\_  
Street Address \_\_\_\_\_  
City, State, Zip \_\_\_\_\_  
Telephone ( ) \_\_\_\_\_ Fax ( ) \_\_\_\_\_

List the Products and/or Services that will be exhibited in your booth:  
\_\_\_\_\_  
\_\_\_\_\_  
\_\_\_\_\_  
\_\_\_\_\_

Exhibitor must show only products or services that are approved by the COMPANIES. If the products or services listed above change, it is the sole responsibility of the exhibitor to notify the COMPANIES in writing, and obtain approval of said revisions prior to the exposition.



UNITED FRANCHISE GROUP WORLD EXPO
APRIL 15-18, 2012

2012 WORLD EXPO
EXHIBITOR WORKSHOP FORM

Company Name (as to appear on signage)
Address
City State Zip
Phone Ext. Fax
E-Mail Address
Authorized Signature
Print Name

Tuesday - April 17, 2012
Workshop Schedule: 4:15 - 5:00 PM & 5:15 - 6:00 PM
Workshops = two 45 minute sessions (\$3,000)

In order to reach the largest number of franchise members, we recommend you present two 45 minute sessions (back-to-back). You can present the same session twice, you can present a Part 1 and Part 2 or you can present two totally different sessions. Please indicate how you will present on the space provided below.

Session 1

Title:

Brief Description:

Presenter: Name Phone: E-mail:

Session 2

Title:

Brief Description:

Presenter: Name Phone: E-mail:

\*\*Presenter to supply required audio-visual equipment and any hand-out copies for their presentation

Total Amount Due: \$

Payment Methods:

Check MasterCard Visa American Express (3 digit code on card)

Credit Card Number Exp. Date

Authorized Signature Date

Send this completed form and your payment to Corporate Events. Your payment must accompany this form in order to be processed. Your prompt attention to this matter is necessary as workshops are awarded on a "first come, first serve" basis.

Make Checks Payable To: World Expo

Mail Form & Check To: Corporate Events
7431 114th Avenue North, Suite #102
Largo, Florida 33773
Phone: (727) 548-7200 Fax: (727) 546-1956
E-mail: info@CorporateEvents-tampabay.com

## 2011 EXHIBIT/ SPONSORSHIP PACKAGES

To provide you and your customers with the quality event you expect and deserve, exhibitors are encouraged to become convention sponsors. On this page you will find five (5) packages from which to choose. As a preferred supplier, you play a vital role in the success of the Expo and command a large share of attention during the event. We have structured varying levels of involvement to allow you to choose a level of participation appropriate to your position in the marketplace. The higher your level of participation, the greater your exposure to your customers. We appreciate your support.

### **Titanium \$50,000 (available for only one of our partners from each brand)**

- Sponsor Exclusively (the prestigious Awards Banquet)
- Booth space (one 20' x 20' island booth – prime location)
- Exclusive attendance to all Expo social events
- Reserved VIP table @ Awards Banquet
- Complimentary meeting room at host hotel for exclusive reception (food & beverage supplied by sponsor)
- Logo carpet inlay at grand entrance of Exhibit Hall
- One (1) full-page color ad in Expo Guide (front inside cover)
- Featured in Quarterly Magazine\*
- Your Banner Ad with website link posted at all UFG brand websites\*
- Verbal recognition during each event as a Titanium Sponsor
- Recognition signage displayed throughout venue
- Show bag insert (promo item or flyer – supplied by sponsor)

### **Platinum \$25,000**

- Choose one (1) event to Sponsor Exclusively (event options on package registration form)
- Booth space (one 10' x 30' booth – prime location)
- Attendance to the event you sponsor
- Attendance to the Welcome Reception and Dance Party
- One (1) full-page color ad in Expo Guide (back inside cover)
- Featured in Quarterly Magazine\*
- Your Banner Ad with website link posted at all UFG brand websites\*
- Verbal recognition during each event as a Platinum Sponsor
- Recognition signage displayed throughout venue
- Show bag insert (promo item or flyer – supplied by sponsor)

### **Gold \$12,500**

- Choose two (2) events to Co-Sponsor (event options on package registration form)
- Booth space (one 10' x 20' space)
- Attendance to the Welcome Reception and Dance Party
- One (1) half-page color ad in Expo Guide
- Featured in Quarterly Magazine\*
- Your Banner Ad with website link posted at all UFG brand websites\*
- Verbal recognition during each event as a Gold Sponsor
- Recognition signage displayed throughout venue
- Show bag insert (promo item or flyer – supplied by sponsor)

### **Silver \$6,000**

- Choose one (1) event to Co-Sponsor (event options on package registration form)
- Booth space (one 10'x 10' space)
- One (1) quarter-page black & white ad in Expo Guide
- Recognition signage displayed throughout venue

### **Bronze \$3,000**

- Choose one (1) event to Co-Sponsor (event options on package registration form)
- Listed in Show Directory as Sponsor
- Recognition signage displayed throughout venue

\* United Franchise Group may choose at its discretion what is appropriate for communication



UNITED FRANCHISE GROUP WORLD EXPO
APRIL 15-18, 2012

2012 WORLD EXPO
SPONSORSHIP REGISTRATION FORM

Company
Address
City State Zip
Phone Ext. Fax E-mail
Print Name Authorized Signature

SPONSORSHIP LEVELS
Choose a level of Sponsorship by placing an "X" in the appropriate box
Titanium (\$50,000) Platinum (\$25,000) Gold (\$12,500)
Silver (\$6,000) Bronze (\$3,000)

Choose the event(s) you would like to sponsor by placing an "X" on the appropriate line in the "Event Sponsorship Opportunities" section below. The Sponsorship Level you choose determines the number of events you can sponsor. All sponsorships are awarded on a "first come, first serve" basis, so please fax this form to Corporate Events TODAY!

EVENT SPONSORSHIP OPPORTUNITIES:

Sunday:

- Texas Hold'em Tournament
Mentor Mixer
Welcome Reception (Platinum Sponsor ONLY)

Monday:

- Franchisee Breakfast
General Session
Beverage Break (in exhibit hall)
Lunch (in exhibit hall)
Beverage Break (workshops)
Special Event Night (Platinum Sponsor ONLY)

Tuesday:

- Franchisee Breakfast
General Session
Beverage Break (in exhibit hall)
Lunch (in exhibit hall)
Beverage Break (workshops)
Global Reception

Wednesday:

- Franchisee Breakfast
Women in Business Breakfast
General Session
Beverage Break (workshops)
Franchisee Lunch
Awards Banquet (Titanium Sponsor ONLY)
HOF Reception

PAYMENT METHODS: \*\*Payment in full must accompany form in order to secure sponsorship.

Total Amount Due: \$

Check (Make Payable To: World Expo)

MasterCard Visa American Express (3 digit code on back of card)

Credit Card Number: Exp. Date:

Authorized Signature Date

Send Form & Payment to Corporate Events:

7431 114th Avenue North, Suite #102 • Largo, Florida 33773

phone: (727) 548-7200 fax: (727) 546-1956

e-mail: info@CorporateEvents-tampabay.com

# SPONSORSHIP OPPORTUNITY MENU

**Need help deciding what to sponsor? Below are short descriptions of the different events held at the 2012 World Expo.**

## **Mentor Mixer**

These are the most successful franchisees in our system. They have the major influence in our network and can easily spread word about your products and services.

## **Welcome Reception for Franchisees/Corporate Staff**

One of the biggest and best events to sponsor. Catch franchisees at the height of their excitement when they first arrive. One of the best attended events of the show. Promotional items option available.

## **Franchisee/Corporate Staff Breakfast(s)**

Be the first partner attendees see in the morning. Includes options for placing promotional items on tables.

## **General Session**

This is one of the major sponsorships. Every franchisee and corporate staff attends (estimated 1,000 attendees). Also will be the sponsor that officially opens the exhibit show each day. Promotional items option available.

## **Beverage Break(s) in Exhibit Hall**

Sponsor the breaks spread throughout the exhibit hall for the convenience of the franchisees.

## **Lunch(s) in Exhibit Hall**

Sponsor buffet style lunch for franchisees, corporate staff and exhibitors. Expect approximately 1,500 people. Help keep the attendees in the exhibit hall during lunch.

## **Workshop Breaks**

Sponsor refreshments for the exhibitor-taught workshops presented Monday afternoon or corporate-taught workshops on Tuesday.

## **Franchisee/Corporate Staff Lunch**

Sponsor lunch for the franchisees and corporate staff on Wednesday (estimated attendance 1,000). One of our most visible sponsorships. Includes options for placing promotional items on tables.

## **HOF (Hall of Fame) Reception**

These are the franchisees with the highest volume stores, many over \$1 million per year. These franchisees have major influence over other franchisees in our system.

## **Special Event Night**

This is something we do at each Expo. Sometimes it is at the host hotel or it is at a unique off-site venue. This event always has great participation by our franchisees and is a great sponsorship opportunity.

United Franchise Group 2012 World Expo

April 15 - 18, 2012  
 Rio All Suites Hotel & Casino  
 Las Vegas, Nevada  
 Pavilion Ballroom

Loading Dock

- Sign-A-Rama:
    - 94- 10x10 booths
    - 5- 10x20 booths
    - 4- 20x20 booths
    - 1- 20x30 booth
  - EmbroidMe:
    - 52- 10x10 booths
    - 2- 10x20 booths
    - 2- 20x20 booths
  - Plan Ahead Events:
    - 18- 10x10 booths
  - BillboardConnection:
    - 24- 10x10 booths
  - General Services:
    - 30- 10x10 booths
    - 3- 10x20 booths
- Plan current as of 12.2.10

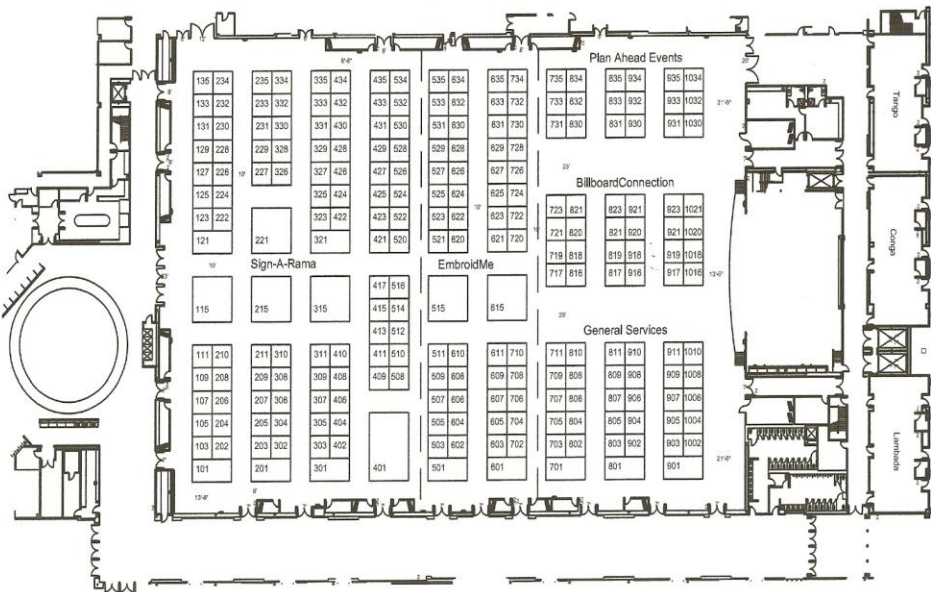

Booth Type	10x10	10x20	20x20	20x30
Count	94	5	4	1
Area	100	200	400	600
Booth Type	10x10	10x20	20x20	20x30
Count	52	2	2	0
Area	520	200	400	0
Booth Type	10x10	10x20	20x20	20x30
Count	18	0	0	0
Area	180	0	0	0
Booth Type	10x10	10x20	20x20	20x30
Count	24	0	0	0
Area	240	0	0	0
Booth Type	10x10	10x20	20x20	20x30
Count	30	3	0	0
Area	300	600	0	0

ENC - WHITE COSS CABINET  
 W - WHITE SATIN PAINT  
 B - BLACK EMPEROR